



Roman Road, London, E3

BUTLER & STAG



Forming part of this New Development on Roman Road is this wonderfully bright and larger than average studio suite. Having the historical Roman Road Market within a moments' walk of the development you really are in the centre of the social hub of Bow, East London.



Leasehold

- Studio Suite
- The Award Winning Victoria Park Close By
- Stylish & Modern Interiors
- Historical Roman Road Market On Your Door Step
- 325 Sq/Ft Internal Living Space
- Chain Free

Comprising a generously proportioned living/bedroom area, separate kitchen and stylish bathroom.

Roman Road is easily accessible to Victoria Park as is the canal tow path which is a hot bed for cyclists and joggers whilst there are excellent local amenities, good bus routes and the nearest station is Mile End Underground (Central, District and Hammersmith & City).



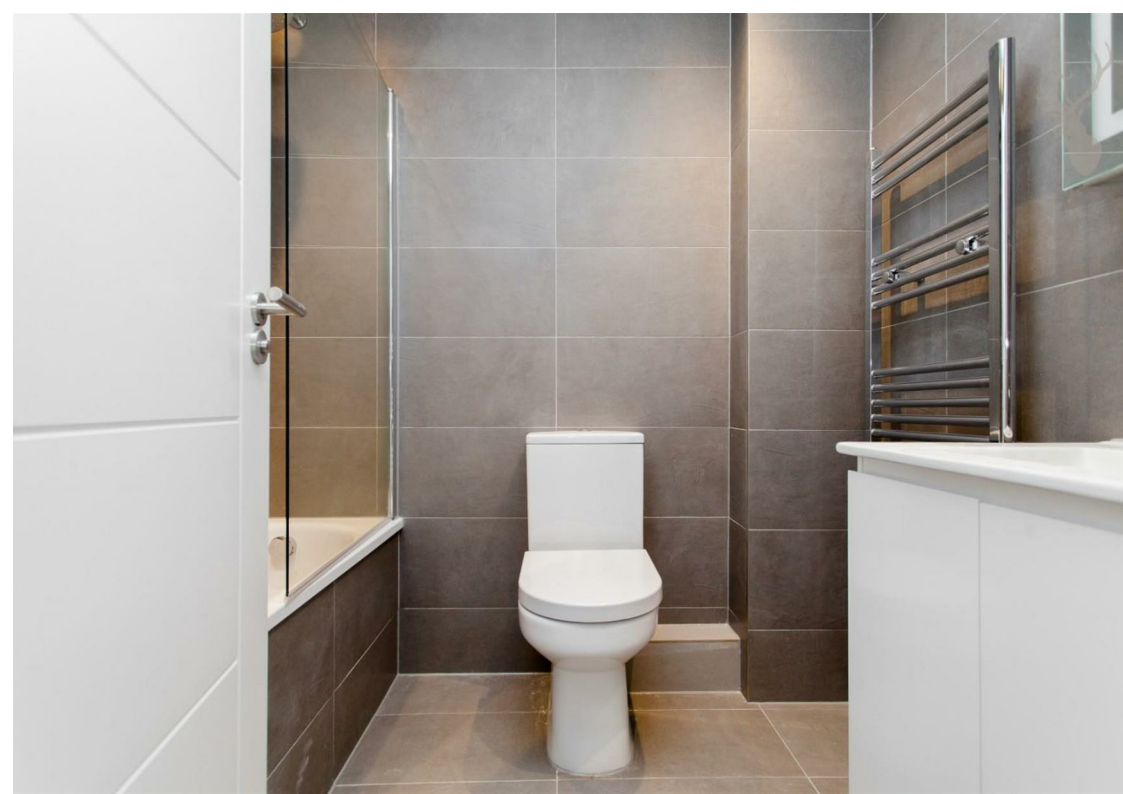

Roman Road, E3

First Floor

Approx. 30.19 Sq. meters (325 Sq. feet)

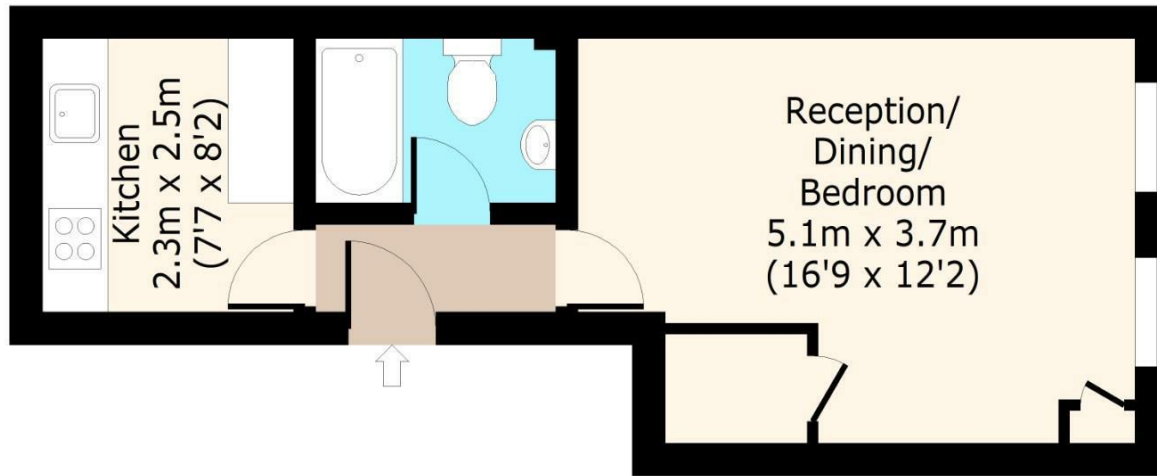
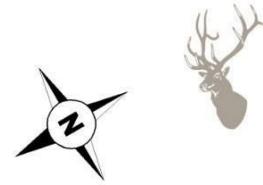

Total area: approx. 30.19 Sq. meters (325 Sq. feet)

For illustration purposes only - not to scale

www.lpaplus.com

BUTLER & STAG

☎ 020 8102 1236

🏠 508 Roman Road, Bow, London, E3 5LU

✉ bow@butlerandstag.com

www.butlerandstag.uk

IMPORTANT NOTICE - These particulars have been prepared in good faith and they are not intended to constitute part of an offer or contract. We have not performed a structural survey on this property and the services, appliances and specific fittings have not been tested. All photographs, measurements, floor plans and distances referred to are given as a guide and should not be relied upon.